

Type TVR5 H₂

Check valve (DN 12 mm)

WEH TVR5 is the largest of our check valves. It is most efficient and developed specifically for hydrogen buses and trucks. The check valve system is designed to minimize the effect that dirt

particles have on the sealing components within the unit. The WEH TVR5 check valve is constructed of high-grade corrosion-resistant steel.



Type TVR5 H₂

Technical Data:

Application:
Check valve for buses and trucks.

Temperature range:
-40°C up to +85°C

Registration:
PED 97/23/EC: CE 0036

Pressure ranges:
350 bar, settled pressure at a uniform gas temperature of 15 °C.
PN = 350 bar
PS = 450 bar
PT = 675 bar

Design:
All parts corrosion-resistant steel. When enquiring for the WEH-TV5 check valve please specify size and type of your connection.
Seals hydrogen compatible.

Dimensions (mm):

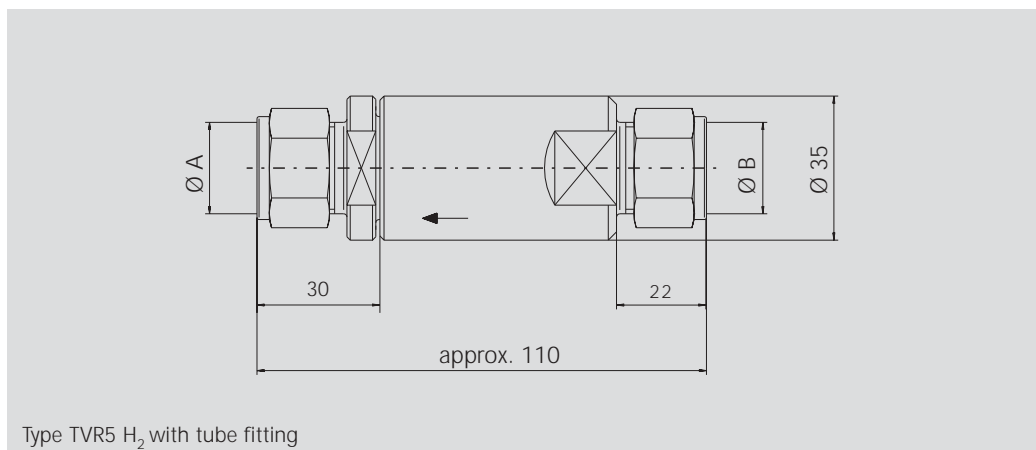
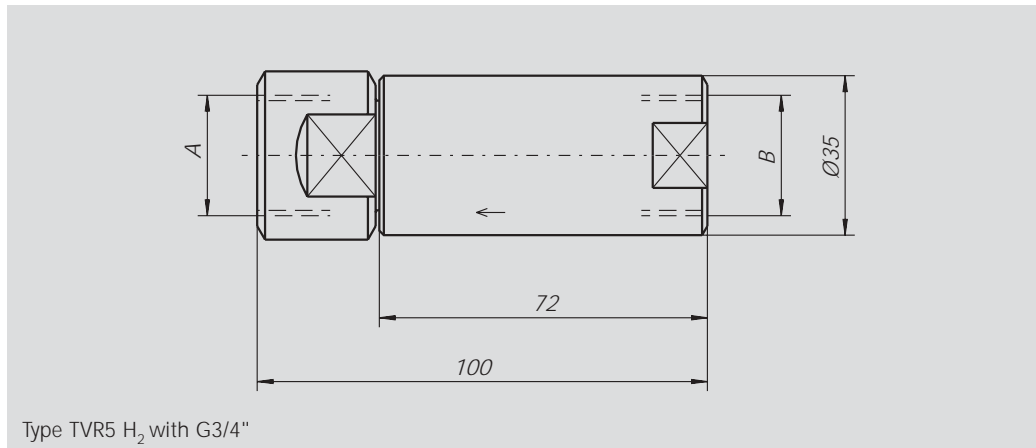

Ordering:

Manufacturer:
WEH GmbH
Gas Technology
Siemensstraße 5
89257 Illertissen
Germany
Phone: +49 7303 95190-0
Fax: +49 7303 95190-9999
Email: sales@weh.com
<http://www.weh.com>

| Description | Inlet A / B* (mm) | Part No. |
|-------------|--------------------------|----------|
| TVR5 | Tube Ø 12 | C1-30216 |
| TVR5 | Tube Ø 16 | C1-30215 |
| TVR5 | G3/4" ** internal thread | C1-43326 |

* Twin ferrule fitting unless other wise specified! ** DIN 3852-2